



User Manual

Mandala Wand



Please read the manual before using the tools.

Version 1.0
Updated February 28th, 2025

1. General Notes

1.1 Product Feature and Intend Use

Mandala Wand is a sleek, portable wellness device designed to restore balance and enhance well-being using advanced light therapy and scalar wave technology. With its powerful quantum and bifilar coils, it helps harmonize your body's energy flow, promoting relaxation and vitality.

Pair it with the **Mandala Wand app**, which allows you to upload and create custom presets for personalized energy balancing. The app also includes built-in preset programs for immediate use. Additionally, by integrating **Mandala Scan**, you can analyze your body's energy state and identify the best coherence preset to upload for optimal results.

Your **Mandala Wand** has been quality-tested and is ready to support your wellness journey anytime, anywhere.

1.2 Safety Warnings

- Check all accessories upon unboxing.
- Read and follow all safety instructions in the manual.

1.3 Warranty

- Your Mandala Wand includes a one-year warranty from the date of delivery.
- If you experience any issues, contact customer support immediately.
- The warranty does not cover damage due to:
 - Misuse or neglect
 - Unauthorized modifications or disassembly
 - Customs/import fees or indirect damage
 - If repairs are needed due to misuse, all costs (including shipping) will be the user's responsibility.

1.4 Important Precautions

- Do not use the device if it appears damaged. Contact support.
- Ensure the correct voltage for your country before use.
- Charge for at least 1 and half hours before the first use.
- Do not disassemble or modify the device.
- Keep dry – avoid rain, high humidity, heat, and dust.

1.5 Maintenance

1. If unused for a while, charge the device for 2 hours before use.
2. Use soft cloth or water-based glass cleaner for maintenance.
3. Keep the device clean to ensure proper performance.

1.6 Product Includes

1. Mandala Wand
2. USB Type-C cable
3. Mandala Bag
4. 3x Symbol Spheres



2. Technical Data

2.1 Specifications

Product name:	Mandala Wand
Case Color:	Gold
Material:	ABS plastic
Input Voltage:	DC 5V / 2A Max
Charging Interface:	USB Type-C
Battery Type:	3.7v / 2000 mAh Li-Po Battery
Operation:	Bluetooth and Bluetooth Audio
Product Size:	57 x 175 x 32 mm (W x H x D)
Gross Weight:	142g
Main Frequency:	0-40MHz (square wave) Bifilar Coil 0-40MHz (sine wave)

2.2 Overview and Function

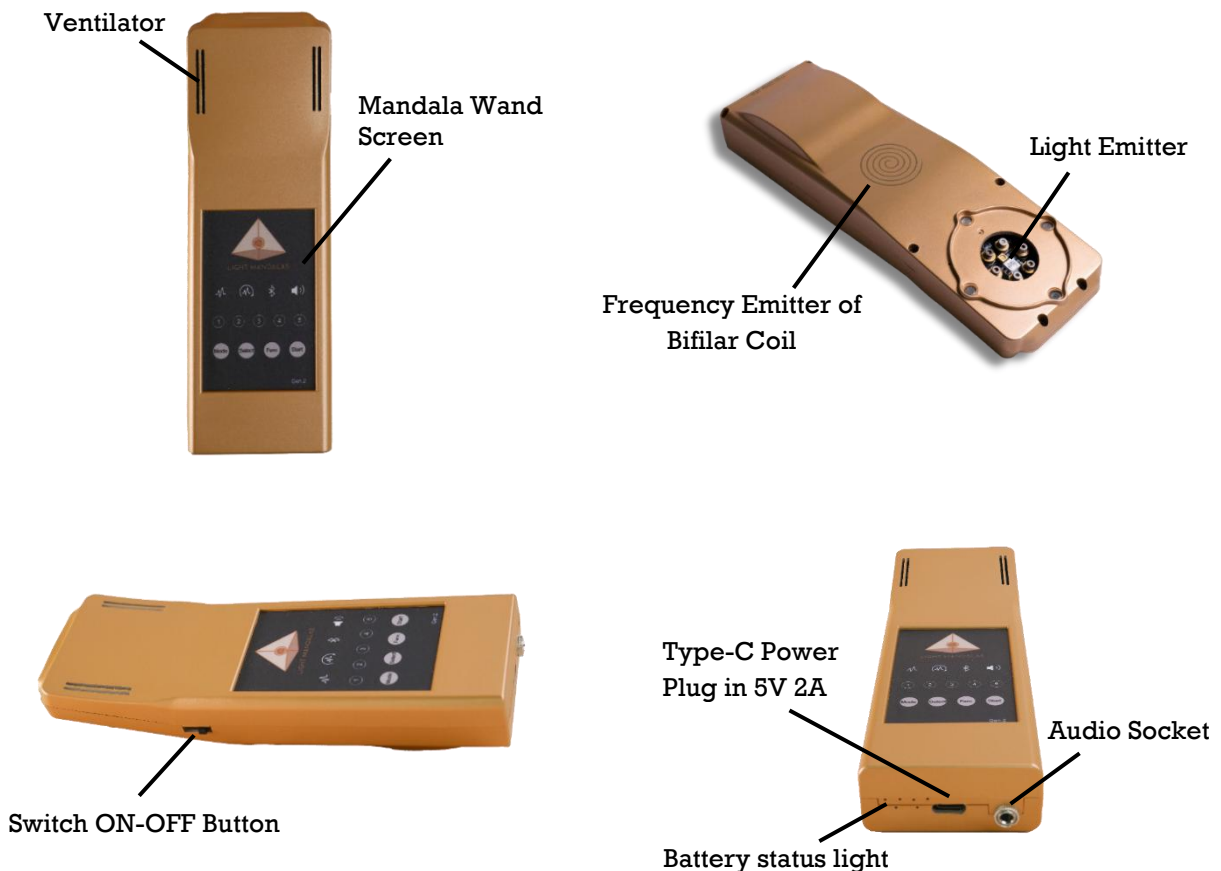

2.3 Crystal Sphere Holder Setup

The holder is designed to fit perfectly on the Mandala Wand. Every holder has a mark on one of the four tips. The mark serves as a guide for the user to align and place the Mandala Wand's top magnet.

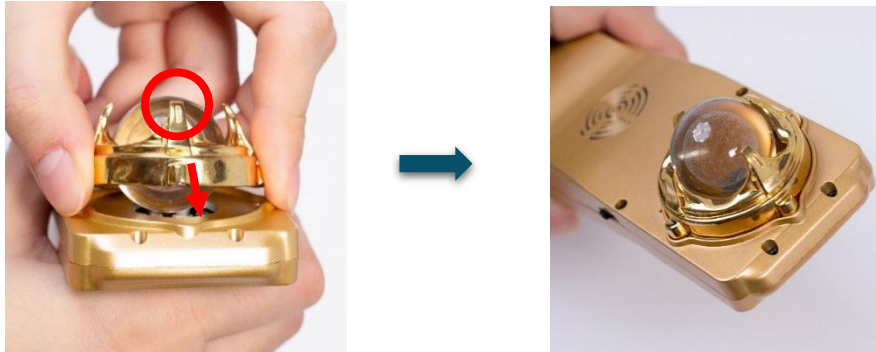

2.4 Charging Setup

1. To charge the Mandala Wand, connect the USB-C cable to the device and a power adapter, then plug it into a power source.

2. Charging takes about 1 and half hours from an empty battery and lasts over 4 hours. *(Battery capacity can be reduced.)*

3. When the battery is low, the status light will be entirely red. When the battery is fully charged, the status light will display red, orange, and green.



To protect the battery life span, please don't overcharge the battery.

2.5 Mandala Wand Operation Instruction

When the device is switched on, wait a few seconds for the initialization process to be completed.

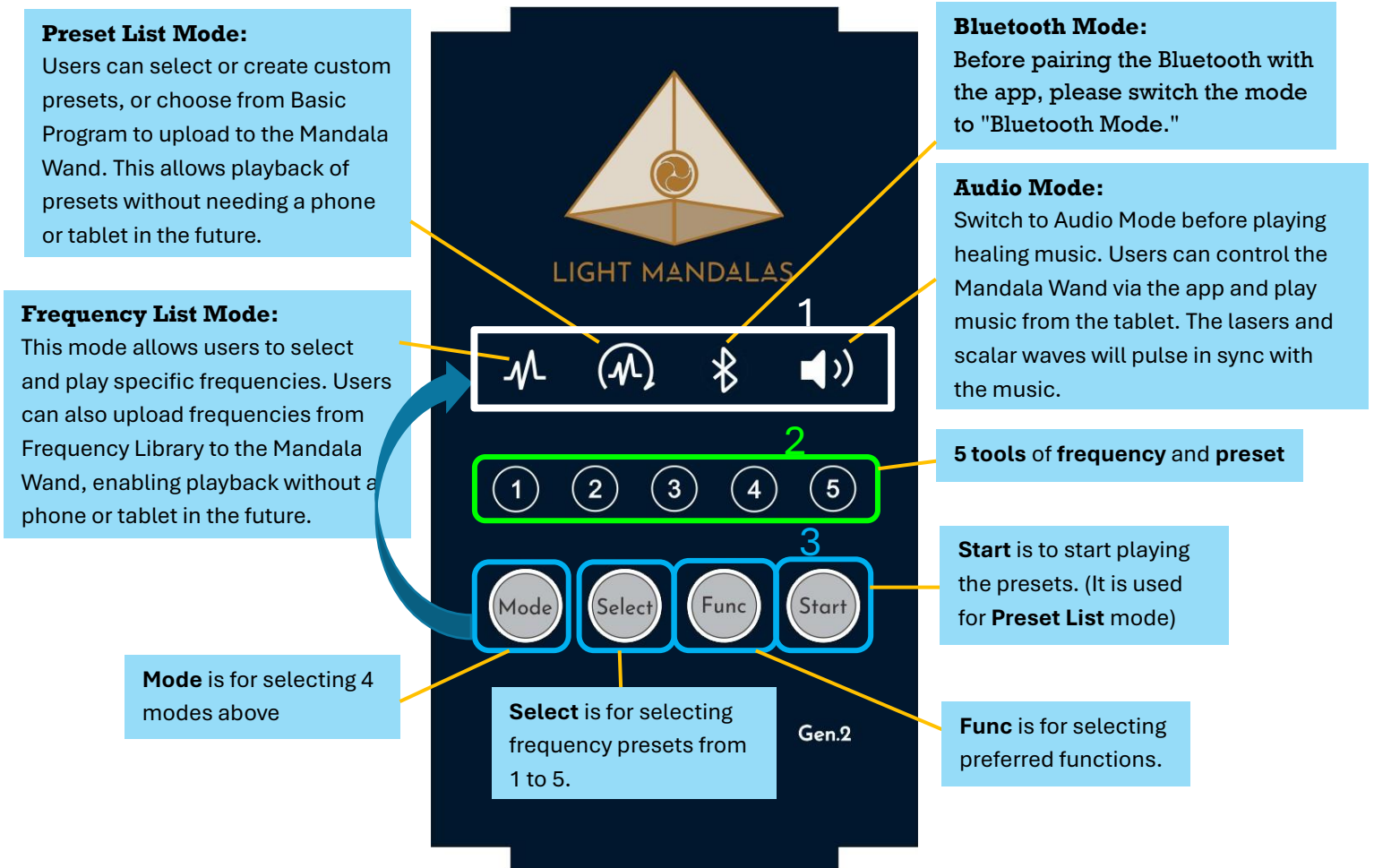

3. Mandala Wand Application

3.1 Application Setup

The Mandala Wand app is available on iOS and Android. Download it from the App Store for iOS or Google Play Store for Android. For users in China, please download it from <https://light-mandalas.com/downloads>

App Store (iOS)

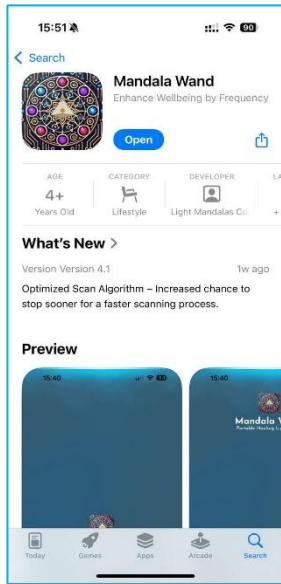

Play Store (Android)

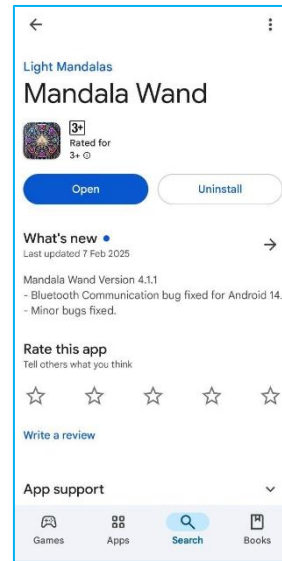

0

3.2 Pairing Bluetooth with Application

Tap the "Settings" icon at the bottom right, then select "Set Up Mandala Wand." The app will search for nearby devices. Choose the displayed serial number to connect via Bluetooth.

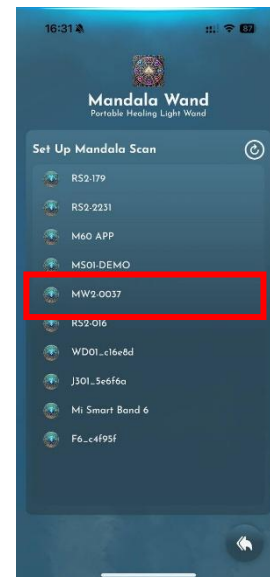

3.3 Basic Program

After setting up the app, select your preferred program under "Basic Program." You can either play the preset or upload it to a slot (1-5) for future use.

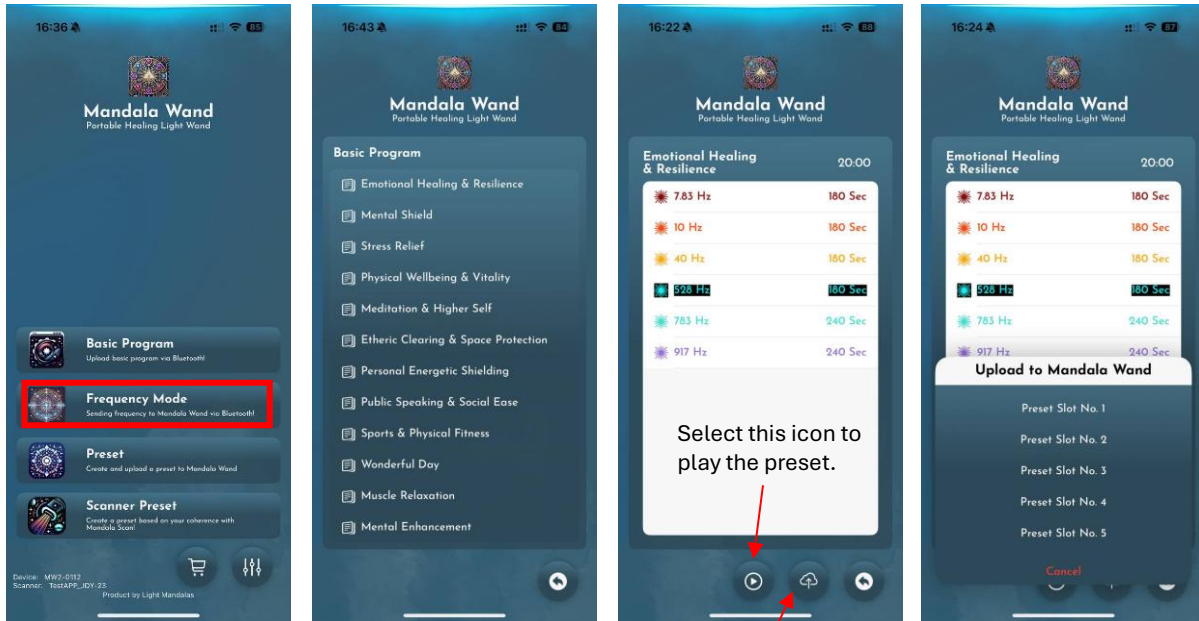

Upload the preset to the device.

3.4 Preset

"Preset" allows users to customize frequency settings using the library or their own frequencies. Users can combine frequencies to create a preset.

3.4.1 Frequency Library

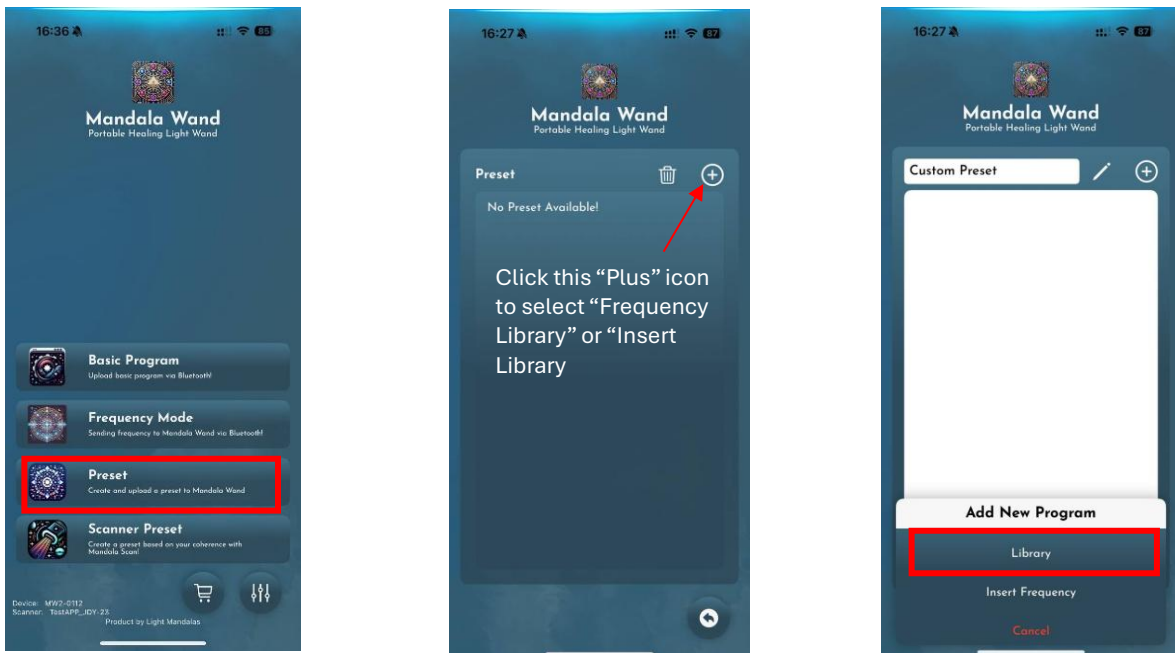

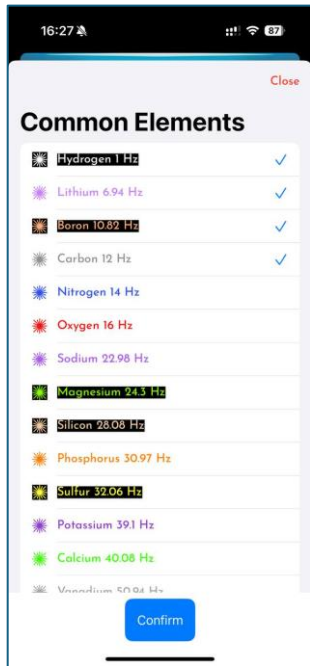
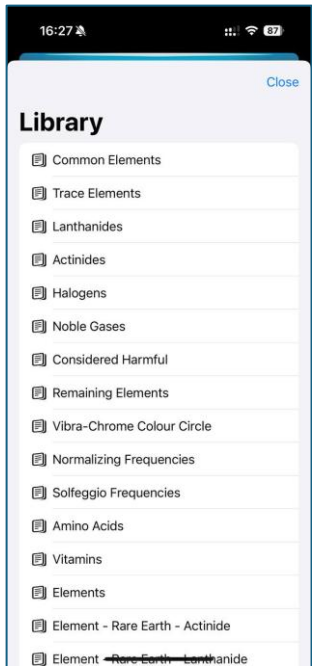

1. Give the name for the preset.

Select the frequency that you prefer to add to the preset, then click "Confirm".

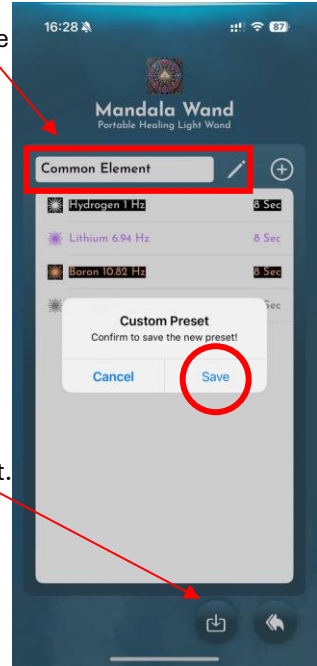

2. Click this icon to save the preset.

3.4.2 Insert Frequency

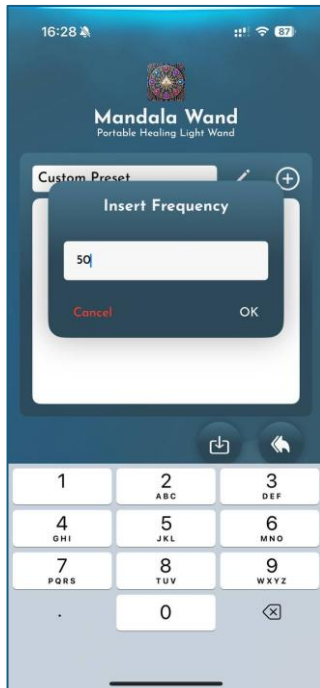
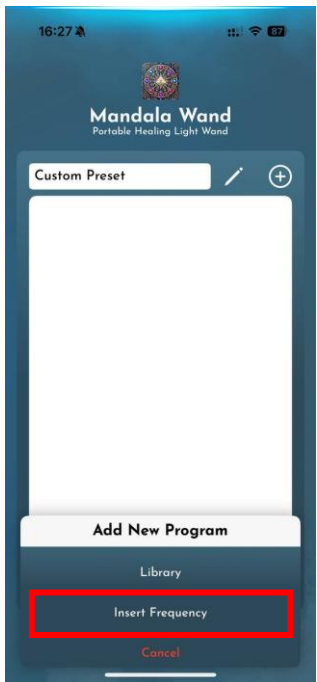

1. Give the name for the preset.

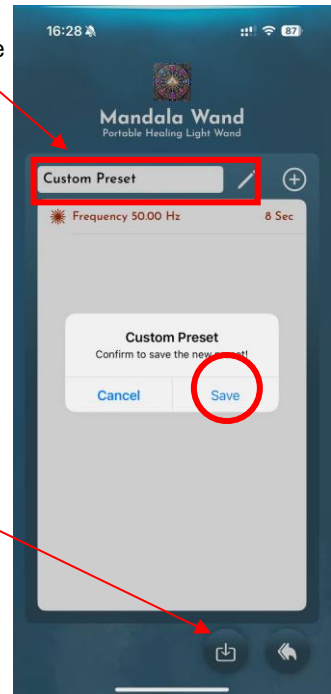

2. Click this icon to save the preset.

3.5 Mandala Scan

To use Mandala Scan, first pair it via Bluetooth. Tap the "Settings" icon, select "Set Up Mandala Scan," and choose the displayed serial number to connect.

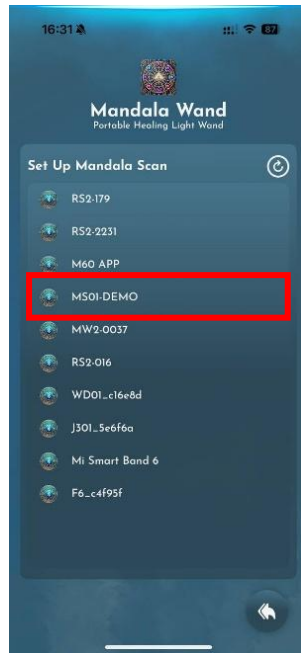

Choose "Mandala Scan" after pairing Bluetooth.

3.5.1 Smart Scan



Smart Scan analyzes your body and identifies the frequencies that best support your needs at this moment.

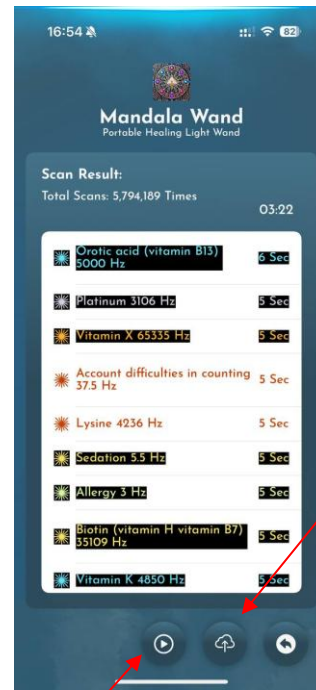

Click this icon to upload the scan results or the frequencies to Mandala Wand.

Tap to play all the frequencies.

3.5.2 Select Library

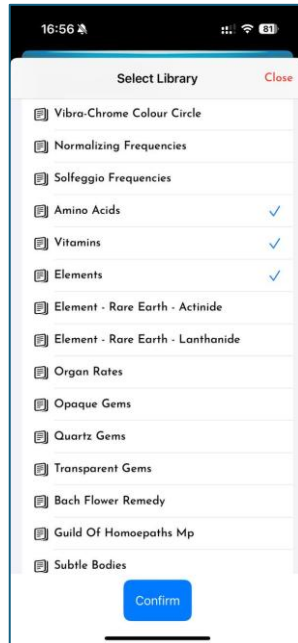

Select the library you want to scan, then click 'Confirm' to begin scanning.

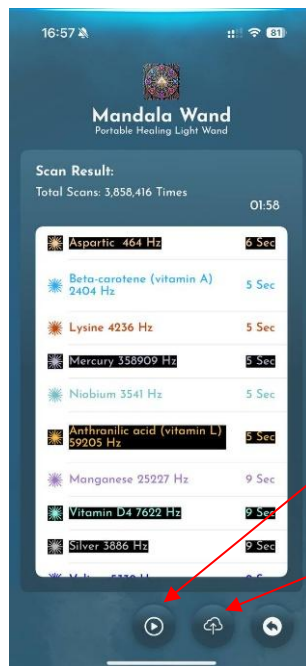

Tap to play all the frequencies.

Click this icon to upload the scan results or the frequencies to Mandala Wand.

3.6 Audio Frequency

Switch to **Audio Mode** on the device's screen. Connect your headphones or speaker to the Mandala Wand, then pair the 'Mandala Wand Audio Bluetooth' in your Bluetooth settings. Once you hear the notification sound through your headphones, you can start playing healing music from any music platform.

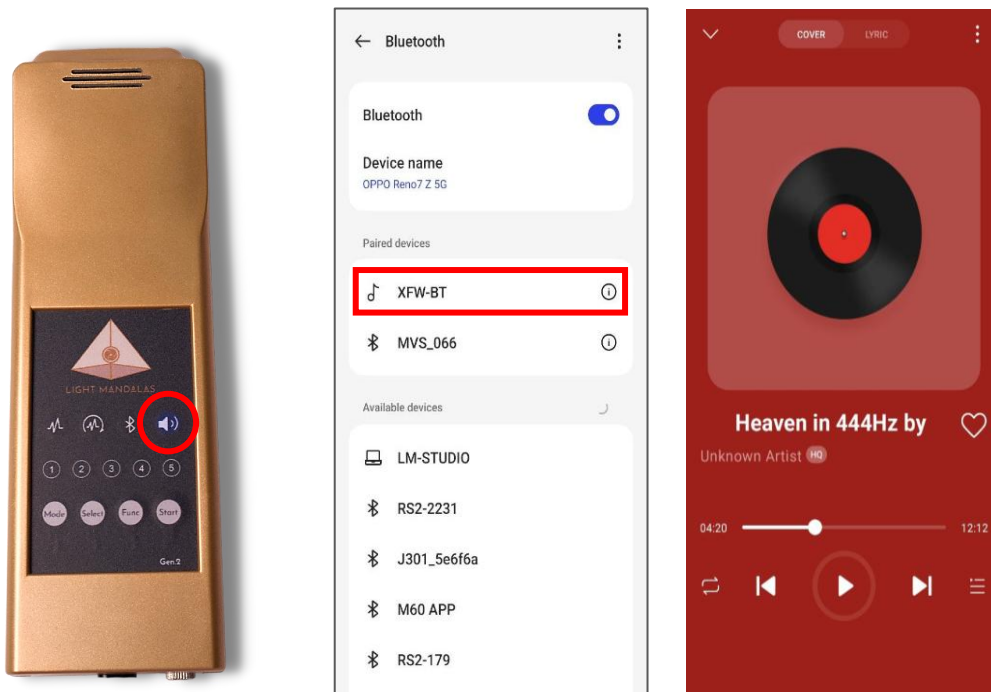

Failures Remedies

Device cannot turn on

- The battery is low. Please charge the device.

Unable to connect with Application

- Make sure the Mandala Wand screen is in Bluetooth Mode.

Disclaimer

Light Mandalas products are designed as energy support tools for relaxation, stress management, and well-being. They are not medical devices and do not replace professional medical treatment or advice.

Any experiences or testimonials shared regarding the use of our products reflect individual responses and are not guaranteed outcomes. Since personal energy and emotional states vary, users may experience different effects, including heightened sensitivity or discomfort. By using our products, you acknowledge that all outcomes are your sole responsibility.

Light Mandalas Co., Ltd. (Thailand) is not liable for any unintended effects, discomfort, or injuries that may arise from product use. If you have any medical concerns, please consult a healthcare professional before using our products.

For any questions, please reach out to us for further support.

Light Mandalas Co., Ltd. (Thailand Headquarters):

- Light Mandalas Website: www.light-mandalas.com
- Email: info@light-mandalas.com
- Instagram: @mandalawave9
- YouTube Channel: Light Mandalas Official
- TikTok: Light Mandalas
- WeChat: Light Mandalas 光之曼陀罗
- Technical Support Email: cservice@light-mandalas.com