



# User Manual

## Mandala Astral Star



Please read the manual before using the tools.

Version 1.0  
Updated March 15<sup>th</sup>, 2025

## 1. General Notes

### 1.1 Product Feature and Intend Use

**Mandala Astral Star** is a cutting-edge, portable wellness device designed to harmonize your body's energy and enhance emotional clarity. It utilizes advanced **laser light technology, magnetic fields, and scalar waves** to promote deep relaxation and energetic balance.

With its **high-frequency laser emissions and scalar wave field technology**, Astral Star stimulates your biofield, supporting overall well-being.

Pair it with the **Astral Star app**, which lets you explore a range of symbolic programs for targeted energetic support. For a deeper experience, integrate **Mandala Scan** to analyze your energy field and discover the most aligned symbols for optimal coherence.

Your **Mandala Astral Star** has been precision-tested for quality and is ready to elevate your energy, anytime, anywhere.

### 1.2 Safety Warnings

- Check all accessories upon unboxing.
- Read and follow all safety instructions in the manual.

### 1.3 Warranty

- Your Mandala Astral Star includes a one-year warranty from the date of delivery.

- If you experience any issues, contact customer support immediately.
- The warranty does not cover damage due to:
  - Misuse or neglect
  - Unauthorized modifications or disassembly
  - Customs/import fees or indirect damage
  - If repairs are needed due to misuse, all costs (including shipping) will be the user's responsibility.

#### **1.4 Important Precautions**

- Do not use the device if it appears damaged. Contact the support.
- Ensure the correct voltage for your country before use.
- Charge for at least one and half hours before the first use.
- Do not disassemble or modify the device.
- Keep dry – avoid rain, high humidity, heat, and dust.

#### **1.5 Maintenance**

1. Turn off the device and turn it back on; in some case the device does not response on the application control.
2. Use soft cloth or water-based glass cleaner for maintenance.
3. Keep the device clean to ensure proper performance.

#### **1.6 Product Includes**

1. Mandala Astral Star
2. AC Power Cord
3. Crystal Holder
4. Universal Symbol Crystal Sphere
5. Support Piece



## 2. Technical Data

### 2.1 Specifications

Input Voltage:	AC100-240V 50-60Hz
Power:	Max. 50W
Laser Power:	Mandala Astral Star (Class 3B)
-Red:	182mW 638nm
-Green:	114mW 532nm
-Blue:	257mW 450nm
Scanning speed:	0-30kpps
Laser Color:	
-White	497mW
-Red	182mW
-Green	114mW
-Blue	257mW
-Yellow	240mW
-Magenta	382mW
-Cyan	374mW
Laser Pattern:	Unlimited Patterns from application control.
Cooling System:	Fan Cooling
Operation temperature:	Indoor (10-35°C)
Case Color:	White
Case Material:	Aluminum and Acrylic
Machine size:	260 x 180 x 90mm
Gross Weight:	3kg

## 2.2 Overview and Function

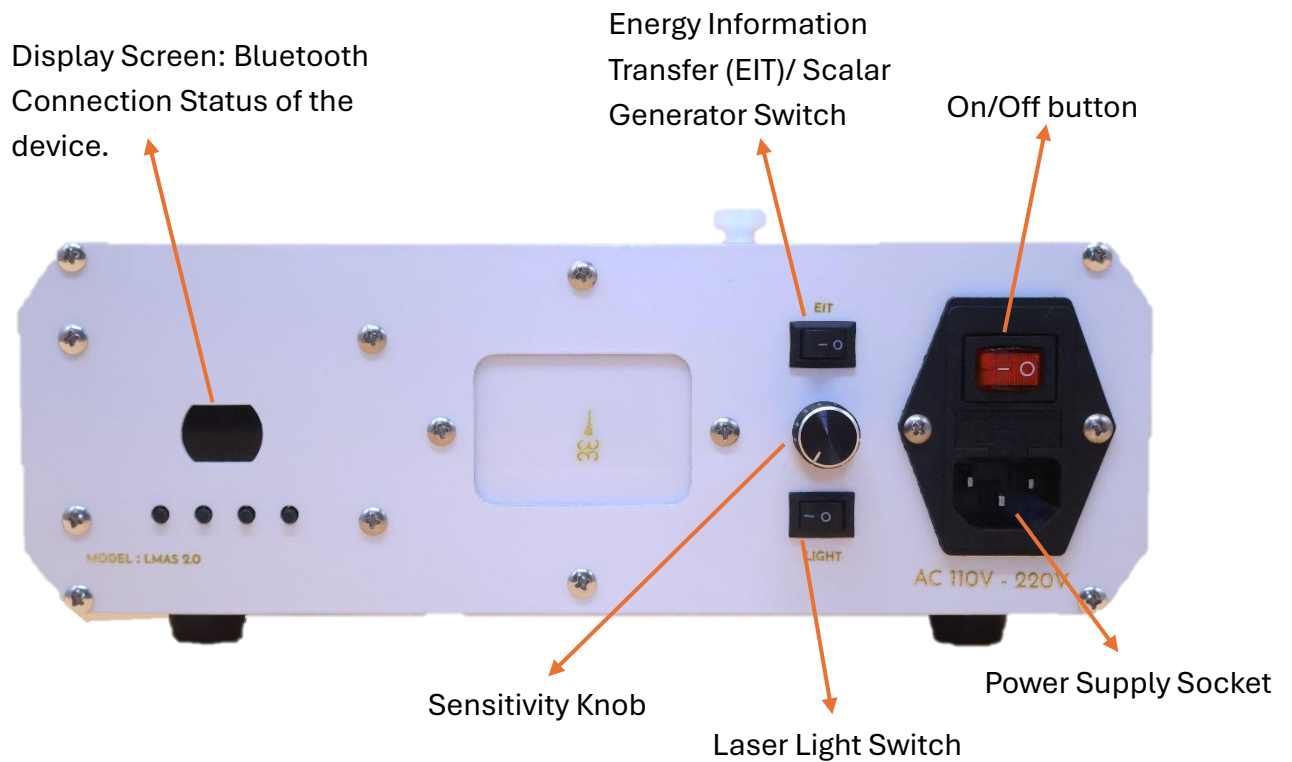

## 2.3 Installation and Operation Instruction

1. Plug in the power cord and turn on the laser light switch to check the laser. Please be cautious with your eyes. Adjust the sensitivity knob to modify the size of the laser pattern.



- **Recommend tunes to 12 O'clock position.**
- **If the tuning is set too low, the laser becomes too concentrated, which may cause burns on the quartz sphere placed in front due to**
- **Tuning too high will cause damage to the symbol generator module.**

2. The device should now be in Standby Mode, displaying default patterns. Ensure the display screen shows "AL," indicating the device is ready to pair with the app. Once the device is Bluetooth-connected and paired with the Mandala Star app, it will display "APP."



**STANBY MODE**



**Bluetooth connected/paired with APP**

3. Install the support piece onto the laser output head. Place the crystal sphere into the holder. Secure both the crystal holder and harmonistic sphere, then lock the crystal holder by tightening the screw.



### 3. Astral Star Application

#### 3.1 Application Setup

The Astral Star app is available on iOS and Android. Download it from the App Store for iOS or Google Play Store for Android. For users in China, please download it from our website.

App Store (iOS)

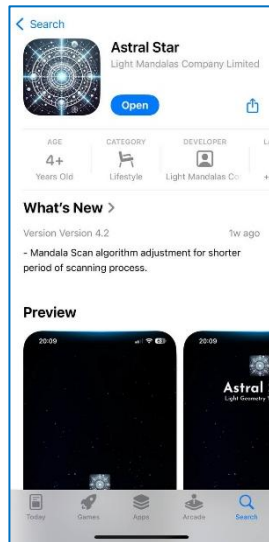

Play Store (Android)

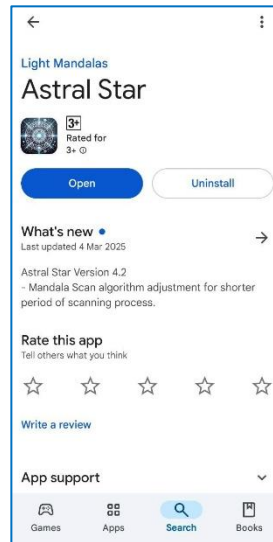

#### 3.2 Pairing Bluetooth with Application

Tap the "Settings" icon at the bottom right, then select "Set up Astral Star." The app will search for nearby devices. Choose the displayed serial number to connect via Bluetooth.

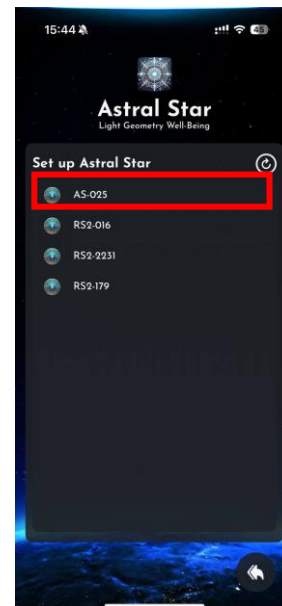
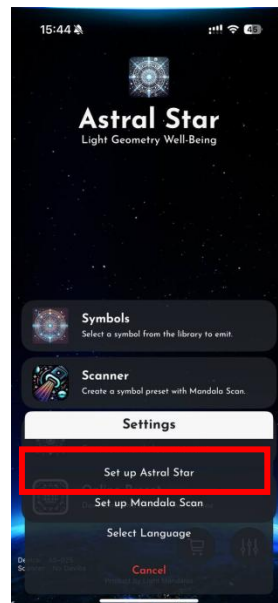

### 3.3 Symbols

The **Symbol** library allows you to explore various symbols representing all frequencies included in the **Astral Star** application. These symbols correspond to different energy patterns, helping you understand and interact with the frequencies available in the app.

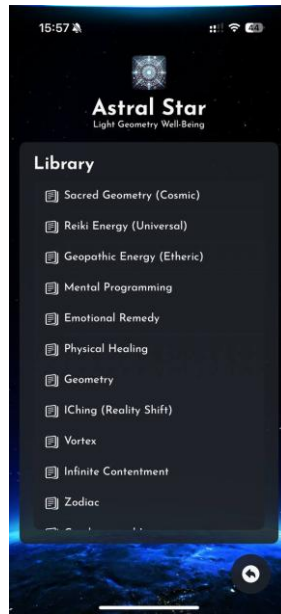
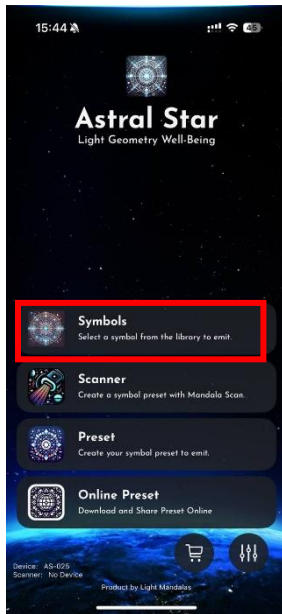

The description of the frequency.

User can change the color of the symbol.

### 3.4 Online Preset

The **Online Preset** provides a selection of healing programs from **Light Mandalas**, including chakra tuning and energy cleansing, designed to support well-being and balance.

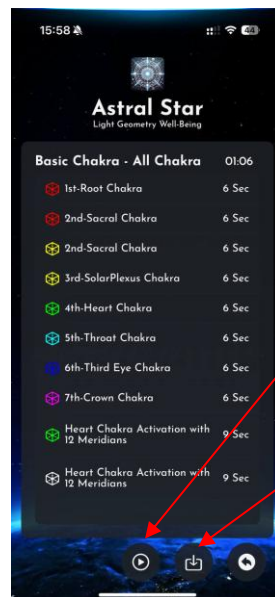
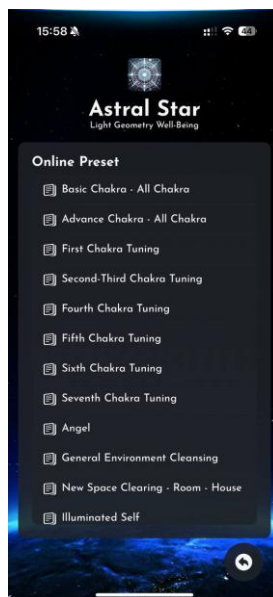
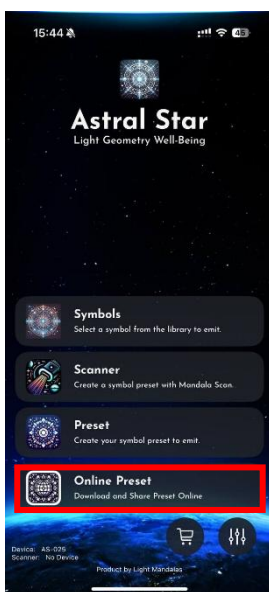

Click this icon to play the program.

User can save to "Preset".



### 3.5 Preset

"Preset" allows users to customize frequency settings using the library or their own frequencies. Users can combine frequencies to create a preset.

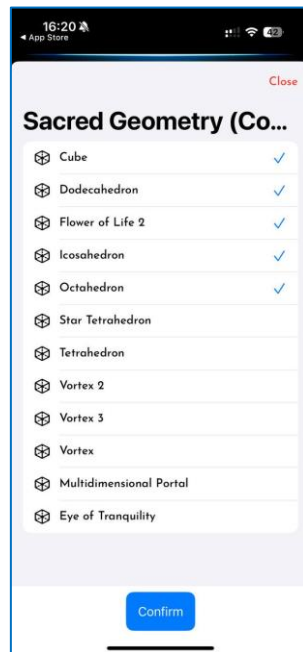
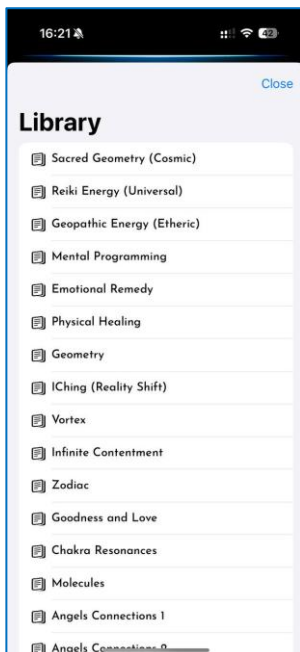
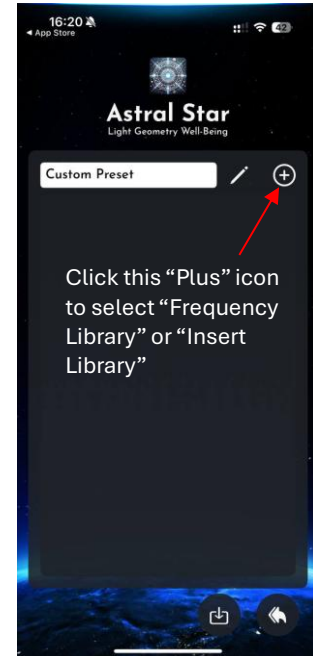
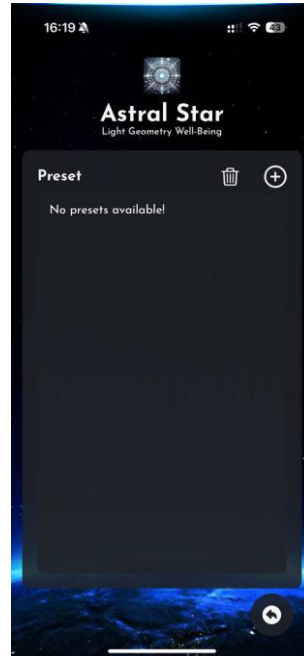
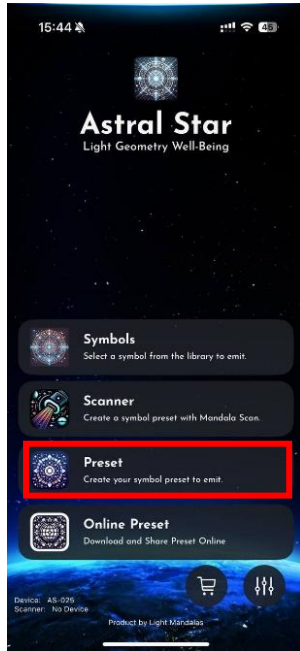

1. Give the name for the preset.

Select the frequency that you prefer to add to the preset, then click "Confirm".

2. Click this icon to save the preset.

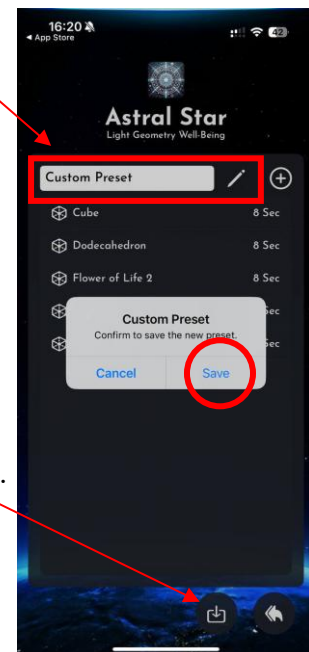

### 3.6 Mandala Scan

To use Mandala Scan, first pair it via Bluetooth. Tap the "Settings" icon, select "Set up Mandala Scan" and choose the displayed serial number to connect.

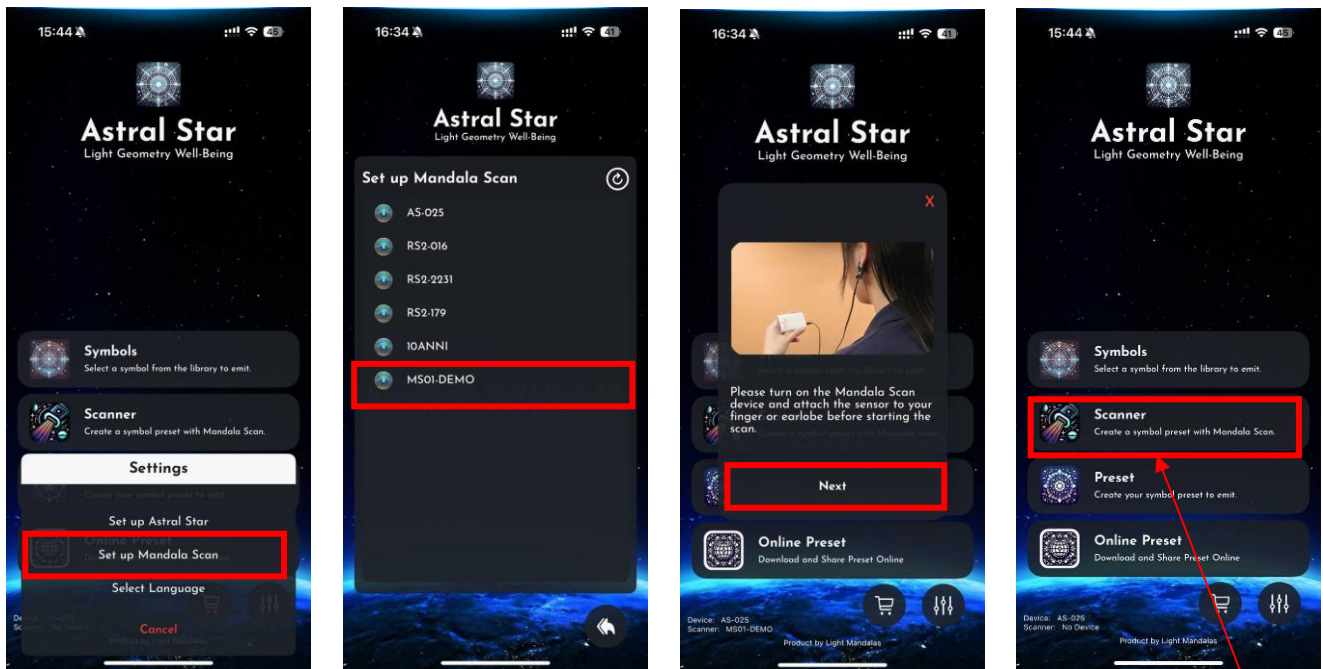

Choose "Mandala Scan" after pairing Bluetooth.

### 3.6.1 Smart Scan

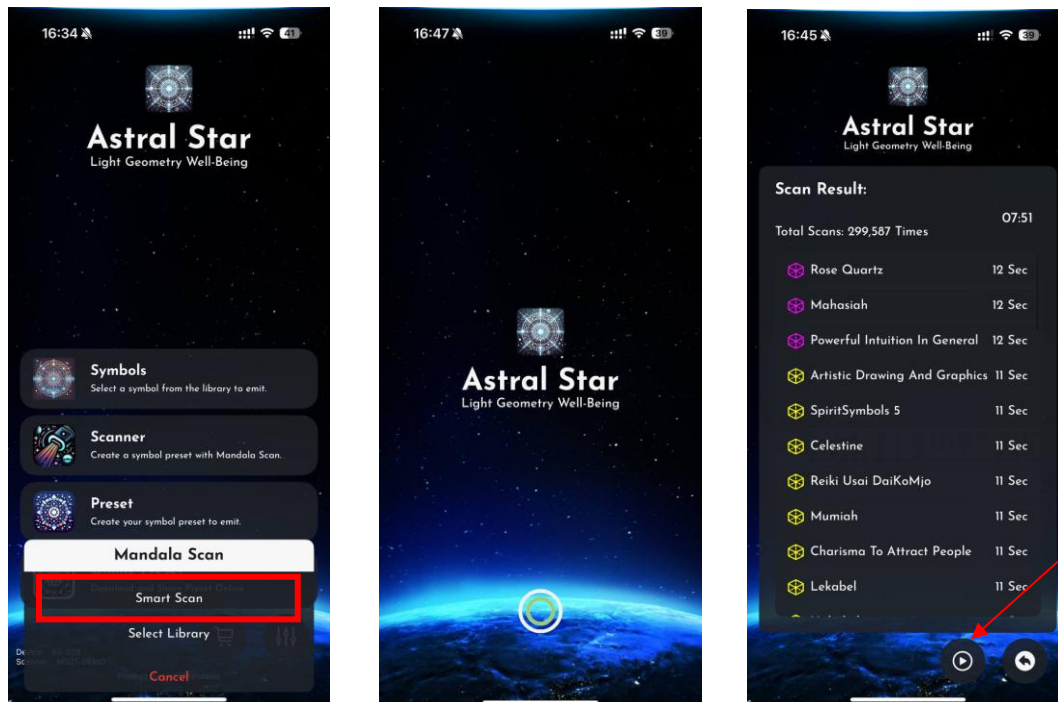

Click this icon to play all the scan results or the frequencies with Mandala Astral Star.

### 3.6.2 Select Library

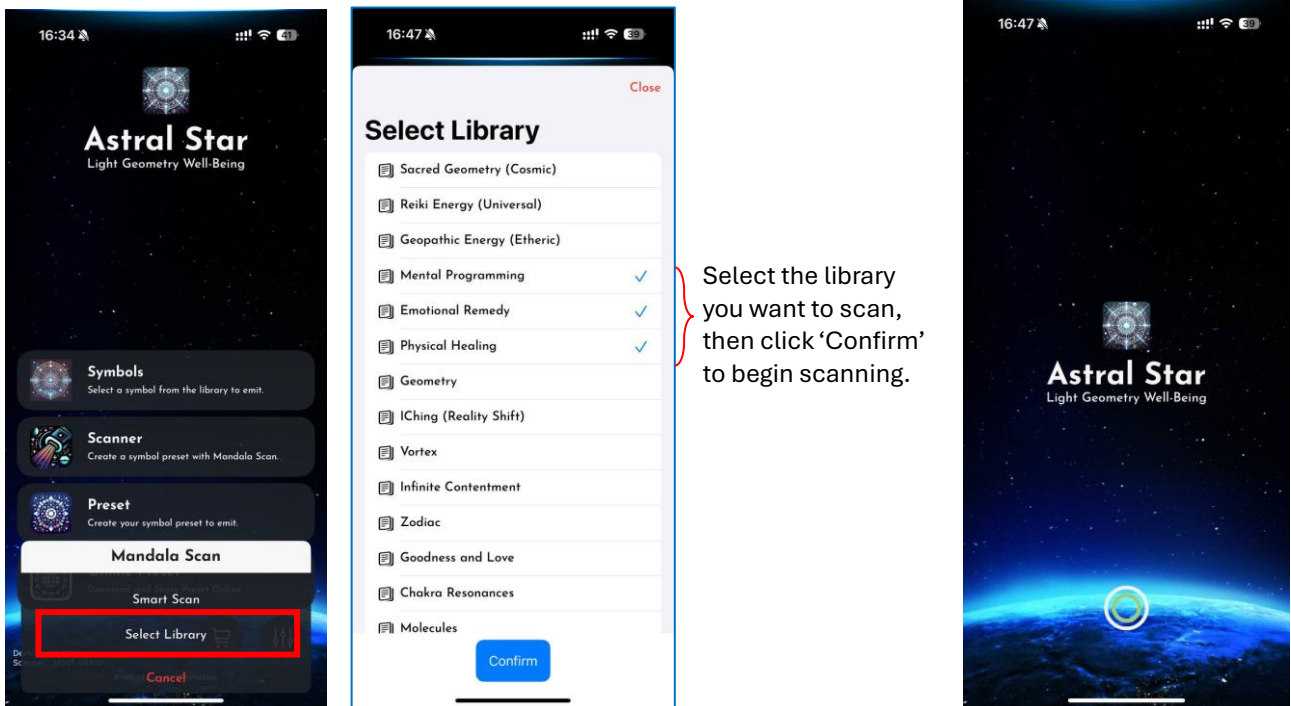

The description of the frequency.

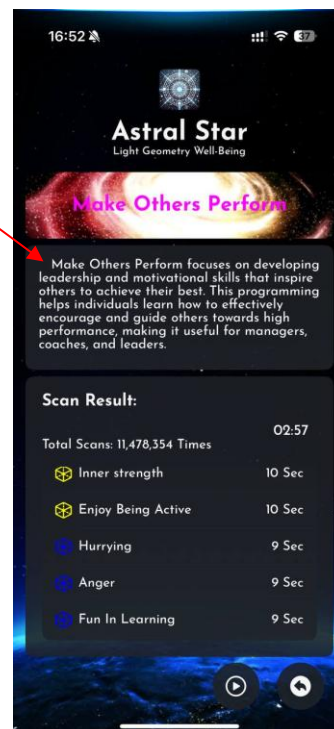

## **Failures Remedies**

### **Device Not Turning On:**

- Ensure the power source matches the required voltage.
- Check if the on/off switch is fully turned on.
- Make sure the power cable is securely plugged in, all the way in.
- Inspect the fuse for any damage.

### **Laser or Pattern Not Displaying:**

- Confirm the Laser Light Switch is turned on.
- Adjust the Sensitivity Knob to modify the pattern size.
- Check if the device is connected to the tablet via Bluetooth. The screen should show “APP” when connected.
- Turn it off and turn it back on to reset Bluetooth connection.

## **Disclaimer**

Light Mandalas products are designed as energy support tools for relaxation, stress management, and well-being. They are not medical devices and do not replace professional medical treatment or advice.

Any experiences or testimonials shared regarding the use of our products reflect individual responses and are not guaranteed outcomes. Since personal energy and emotional states vary, users may experience different effects, including heightened sensitivity or discomfort. By using our products, you acknowledge that all outcomes are your sole responsibility.

Light Mandalas Co., Ltd. (Thailand) is not liable for any unintended effects, discomfort, or injuries that may arise from product use. If you have any medical concerns, please consult a healthcare professional before using our products.

***For any questions, please reach out to us for further support.***

Light Mandalas Co., Ltd. (Thailand Headquarters):

- Light Mandalas Website: [www.light-mandalas.com](http://www.light-mandalas.com)
- Email: [info@light-mandalas.com](mailto:info@light-mandalas.com)
- Instagram: @mandalawave9
- YouTube Channel: Light Mandalas Official
- TikTok: Light Mandalas
- WeChat: Light Mandalas 光之曼陀罗
- Technical Support Email: [cservice@light-mandalas.com](mailto:cservice@light-mandalas.com)